

Existing Site Plan (1:200)

KEY PLAN

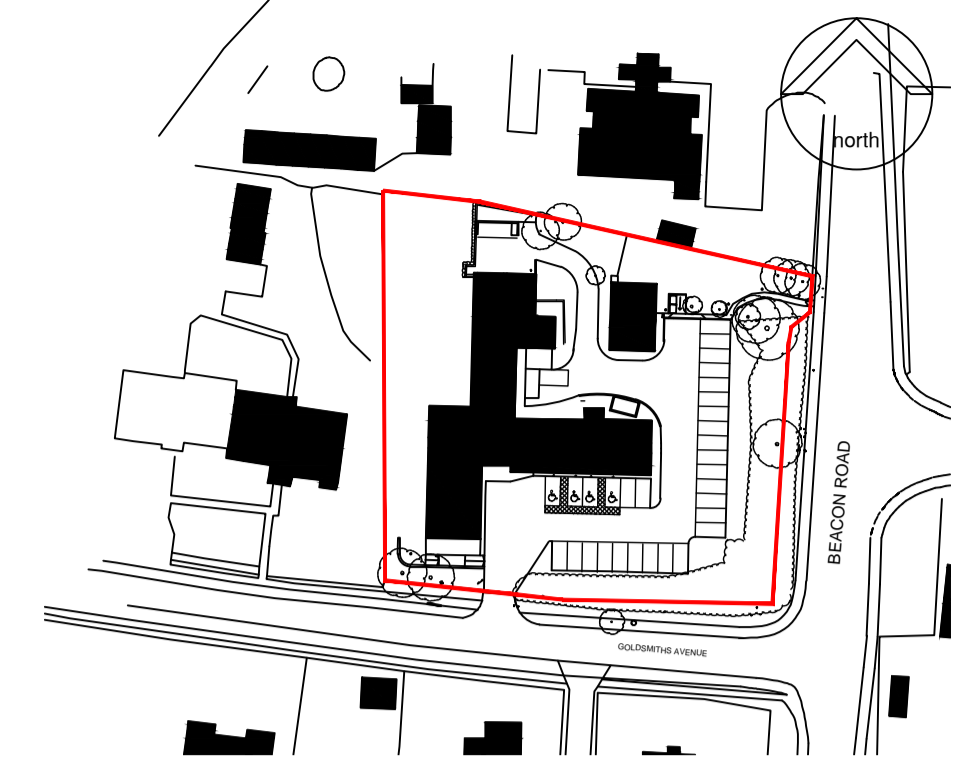

NOTES:

This drawing is produced for use in this project only and may not be used for any other purpose. NPS Property Consultants Ltd accept no liability for the use of this drawing other than the purpose for which it was intended in connection with this project as recorded on the title block fields 'Purpose for Issue' and 'File Status Code'.
 This drawing may not be reproduced in any form without prior written agreement.
 Do not scale from the drawing, use written dimensions only.

REVISED BY:	DATE:	CHECKED BY:	DATE:
-------------	-------	-------------	-------

SCALE BAR

PURPOSE OF ISSUE **PL**

FILE STATUS CODE **S2**

© COPYRIGHT NPS GROUP
 Ordnance Survey mapping reproduced by permission of ?????? ADD & Controller of HM Stationery Office Crown Copyright. **A1**

Hamson Barron Smith
 Townshend House
 30 Crown Road, Norwich
 Norfolk, NR1 3DT
 TEL: 01603 227100
 EMAIL: mark.payne@hamsonbarronsmith.com

CLIENT
East Sussex County Council

PROJECT
**Hookstead HFE, Crowborough
 Refurbishment Project**

TITLE
Existing Site Plan

SCALES	DATE	DRAWN	CHECKED
1:200	May 16	MP	DB

FILE / DRAWING NAME	REV CODE
PROJECT NR 16-1-1286 DRAWING FIELDS HBS-DR-B UNIQUE NR 012	P2